

Compliance Trends

Dave Fredrickson

Director of Investigation and
Compliance

Compliance Trends

- Cases we investigate
- Pesticide Issues – Ag & Non Ag
 - Containment and Worker Protection
 - Feed, Fertilizer/Soil & Plant, Seed
 - Containment
 - Groundwater
 - Remediation
 - Toxic Response

Compliance Trends

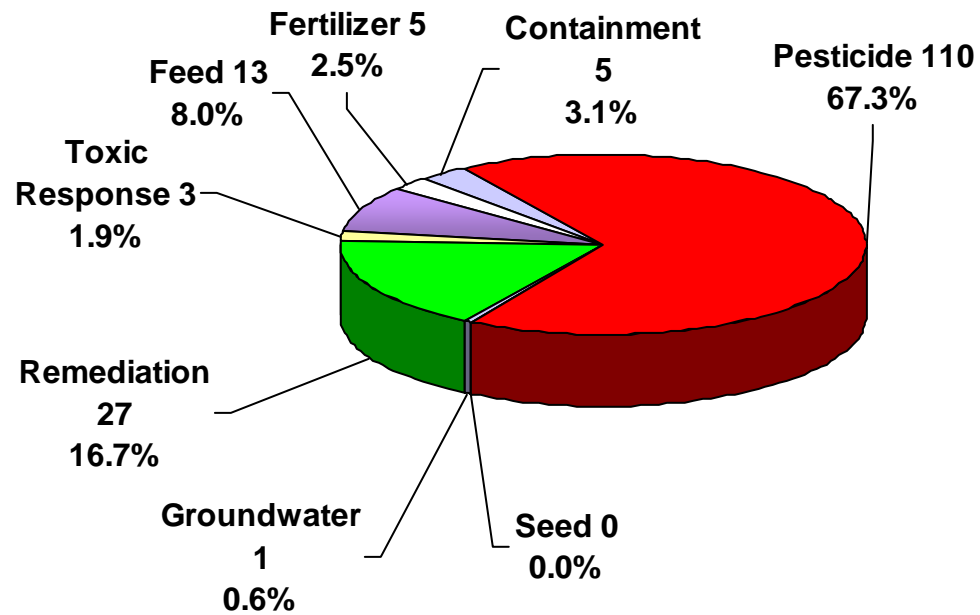

Compliance Trends

- Drift Complaints
 - Are **SIGNIFICANTLY** Lower
 - Violations rates have remained the same
 - Technology or Better Decision making?
 - Sensitive sites are a bigger factor

Compliance Trends

- Drift Complaints

- 1997 79 complaints 2004 34 complaints

- 1998 63 complaints 2005 33 complaints

- 1999 104 Complaints 2006 31 complaints

- for the 3 year total a 60% reduction

Compliance Trends

- Drift Complaints
 - 1997-99 violation rate of 37% (90/246)
 - 2004-06 violation rate of 38% (37 of 98)

Compliance Trends

- Sensitive Site Issues are Increasing
 - Vineyards
 - Organic Production

Your Application begins with Product Selection

(Chlorophenoxies Near Sensitive Plants)



Sensitive sites – Organic Clover



Pesticide Cases Ag vs NonAg

- In early to Mid 90s Ag – 60%
- By 2000 Ag – 50%
- 2004 – 2006 55% NonAg

Violation Rates

VIOLATION RATES 2002 - 2006

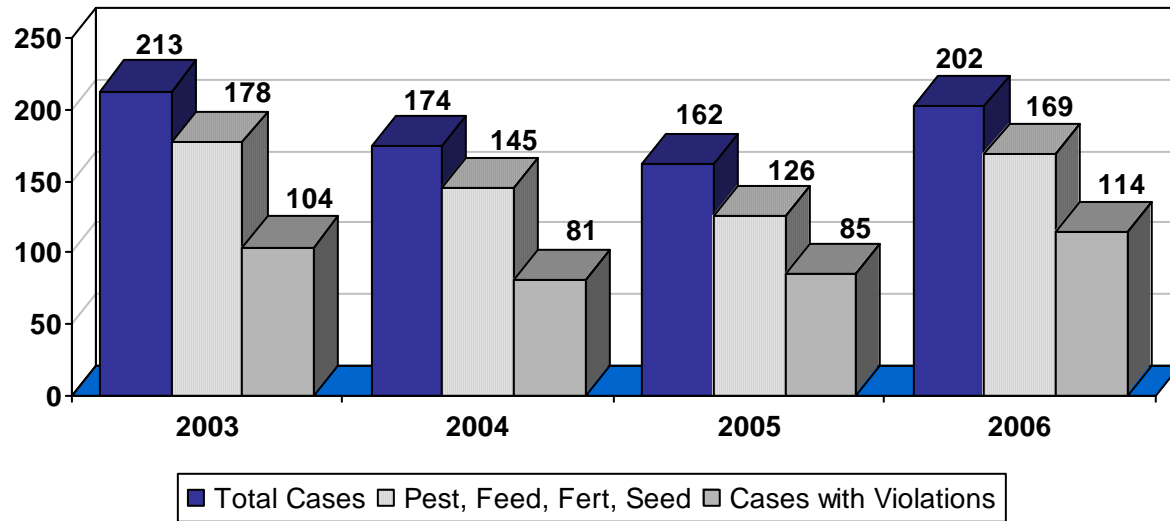

Common Violations

- Based on Inspections and cases the number one violation is - Bad Records
 - Missing or incorrect EPA Reg. Number
 - Applicator records and Restricted Use Sale Record
 - Accurate descriptions of Application site
 - Start and stop times
 - Leave Behind Information lacks notice of availability of labels

Application Records

- S. ATCP 29.21 Wis. Adm. Code
 - First and last name of Applicator
 - Full name and address of Customer
 - Crop or site of the application
 - **Specific** Location of the Application

Application Records

- Month, day and year of the Application
- Starting and Stop times of the Application
- Brand or Product name **AND** EPA Reg. #
- Either concentration and total quantity applied
OR Amount per unit area and total area
treated

Applicator Records

- Location where the Pesticide was mixed or loaded into the Application Equipment, If it was mixed/loaded away from your Business Location

Location of Fields

Patron Name: _____ Date: _____ First Pass 2nd Pass

Address: _____ Start Time: _____ Stop Time: _____

Field Name/Location: _____ Acres Treated: 5 8.00

Brand Name Chemicals	Container or Formulation	EPA Reg #	Rate / Acre	Total in Load
<u>Lumax</u>	<u>Bulk</u>		<u>2.5 gal</u>	<u>3.13 gal</u>
<u>Aim D</u>			<u>102</u>	<u>502</u>

Carrier: Water 28% ECT: _____ Rate / Acre: 15 Total in Load: _____

Crop: Com Soybeans Alfalfa Other _____ Stage of Growth _____

Pests to be controlled: Weeds Weed Height: 0 Insects _____ Comments: _____

Application: Preplant Pre-Emerge Post-Emerge _____

Wind Direction: SW Wind Speed: 5-10 Temperature: _____ Soil: Wet Moist Dry

Soil Condition: Level Rough _____ Texture: Fine Cloddy _____ Residue on Surface: Light Moderate Heavy _____

Re-Entry: 12 HRS 24 HRS 48 HRS _____ Other: _____ Customer Signature: _____

Comments: _____

Ticket #: _____ Equipment #: _____ Pre-Harvest Interval: _____

Product	EPA#	REI	Product	EPA#	REI
Aatrex 4L	100-497	12	Harness	524-476	12
Aatrex Nine-O	100-585	12	Harness Xtra	524-480	12
Accent	352-560	12	Hornet	62719-253	48
Accent Gold	352-612	48	Keystone LA	62719-479	12
Atrazine 4E	2749-336-534	12	Liberty	264-660	12
Atrazine Nine-O	19713-11-1386	12	Lorsban 4E	62740-228	24
Banvel	55947-1	24	Lumax	100-1152	24
Basagran	7969-58	48	Merkman	55947-39	48
Beast	352-571	12	Northstar	100-623	12
Baythroid	3125-351	12	Option	264-685	12
Brdatrk Treflan	62719-222	12	Pendimax	68156-6-62719	24
Buctril	264-437	12	Permit	524-465	12
Callisto	100-1131	12	Poast Plus	7969-77	12
Camik	100-1148	12	Princep Cal 90	100-603	12
Celebrity Plus	7969-150	12	Prowl 3.3 EC	241-337	12
Clarity	5597-46	12	Prowl H2O	241-418	24
Defline SC	264-819	12	Pursuit Eco-Pak	241-350	12
Distinct	7969-150	12	Python	62719-277	12
Dual II Magnum	100-818	24	Quadris	100-1098	4
Durango	62719-322	12	Raptor	241-275	4
Extreme	241-MO-001	12	Roundup Orig Max	524-538	4
Fieldmaster	524-497	12	Roundup Wthr Max	524-537	4
First Rate	62719-272	12	Select	59639-3	24
FS Amine	1386-43-534	24	Sencor DF	3125-324	12
FS Glyphosate *	524-54534	12	Steadfast	352-608	12
FS LV 400	1386-60-534	24	Surpass EC	10182-325	12
Fultime	10182-419	12	Topnotch	10182-391	12
Furadan 4F	279-2878	48	Touchdown	100-1117	12
Glyphomax XRT	62719-322	4	Valor	59639-99	12
Gramoxone Max	100-1074	12	Warrior	100-1112	24

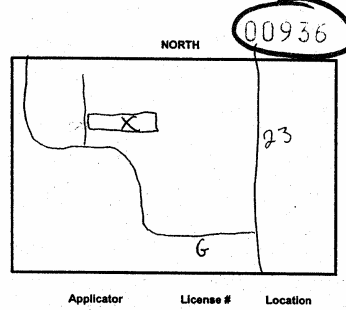

Indicate Mix / Load site 1/4 mile radius of last site if using 1500 or more lbs of active ingredient combined pesticide

Was the Tank Rinsed: Yes No

Water Tank Cleaner Ammonia

①

Farm 3993 Tract 2550
Vernon Co. FSA Service Center
Op: K&B FARMS PARTNERSHIP
Ow: SHIRLEY SANWICK

①

Fl	Acres	Crop	HEL	Cry
1	14.25		Y	
2	55.25		Y	
3	28.09		Y	
4	5.76		Y	
5	11.85		Y	



* Spray 5 ac
in field # 3
(or 2 passes
If you can
spray across
rows as indic
please do.

Section Corner

Common Violations

- Unlicensed/uncertified applicators or Unlicensed Business
 - Bigger problem in Non Ag areas than in Ag
 - All violations are addressed
 - Given an opportunity to comply
 - Get out of Business – Order
 - Pay a civil forfeiture for past violations

Common Violations

- Of 88 completed Court cases in last 2 years :
 - 26 Involved license/certification issues
 - 13 Uncertified Private Applicators using RUPs
 - 3 Agricultural businesses
 - 10 Non agricultural businesses
 - » 2 Criminal cases – \$10,000 fines

Common Violations



Common Violations



Common Violations

- Information to and from customers for Worker Protection
 - Notice on pesticide to be used – Including EPA Reg. No.
 - Notice of reentry intervals
 - Notice from customer of pesticides applied

Emerging Violations

- Use of Atrazine in Prohibition Areas
- Over application of Atrazine in Non Prohibition Areas
- Using combination products that contain Atrazine

Atrazine Containing Products

- Lumax Bullet BicepLite II
- Brawn Cinch Lexar
- Charger Lariat Fieldmaster
- Harness Extra Shotgun

Emerging Violations

- Equipment used to haul Treated Seed
 - Trucks
 - Gravity boxesNot cleaned or Inadequately Cleaned

Same equipment used to Haul Grain in the Fall
Federal Food, Drug and Cosmetic Act Defines
Adulteration

Annoying Violations

- Golden Malrin Fly bait
 - Numerous Internet sites recomend mixing with Pop, (Coke is preferred on many sites)
 - Use to get rid of raccoons, skunks nuisance animals
 - Has Killed numerous dogs and valued species
 - Can be handled by Wardens or DATCP